

ROCKO

Flooring by Kronospan

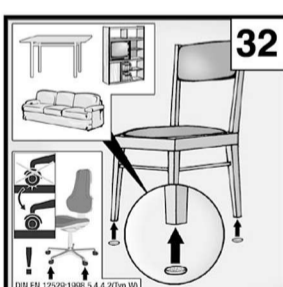
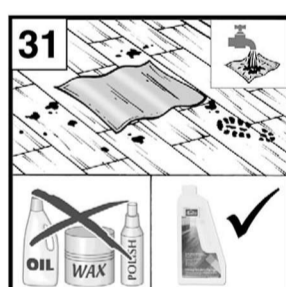
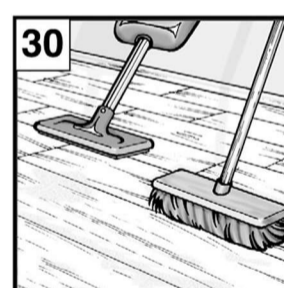
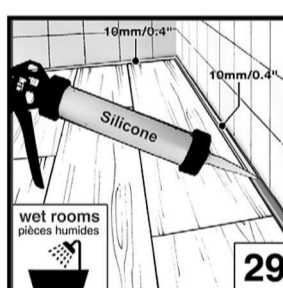
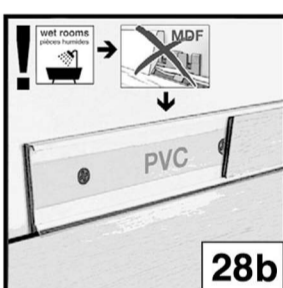
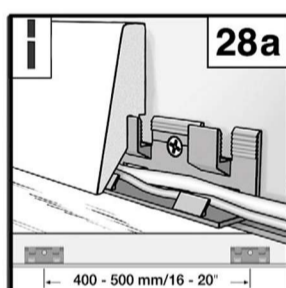
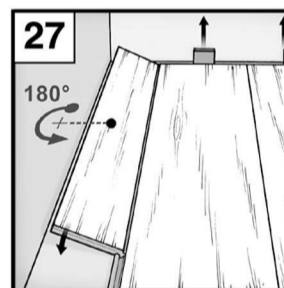
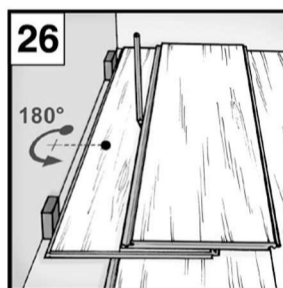
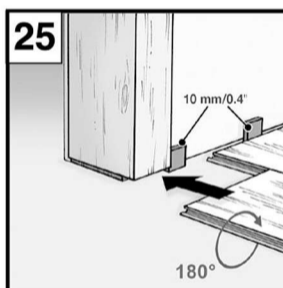
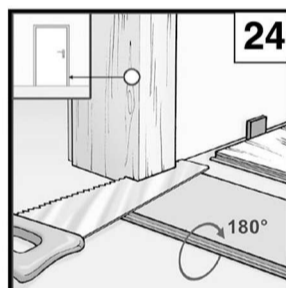
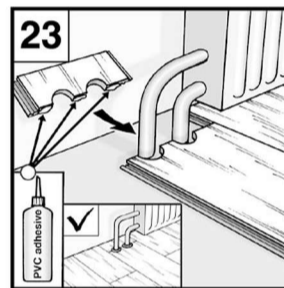
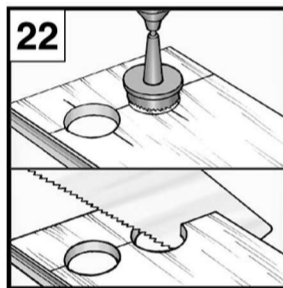
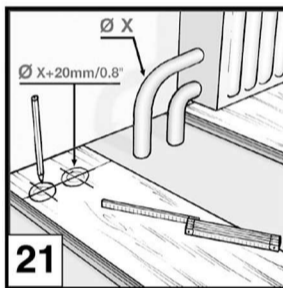
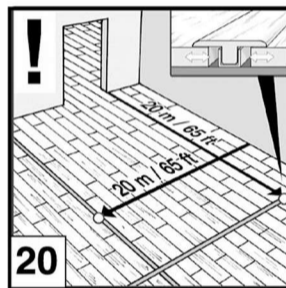
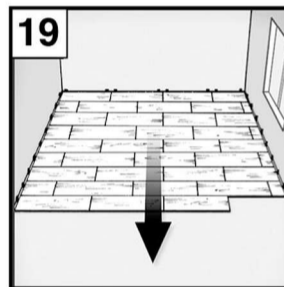
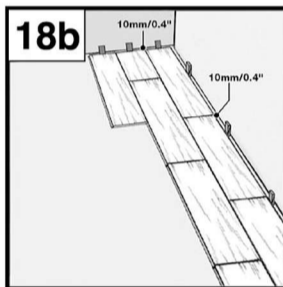
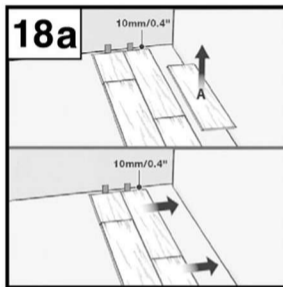
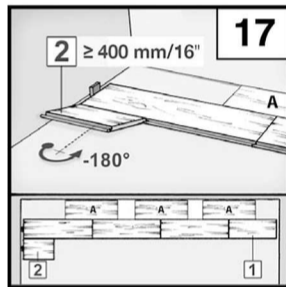
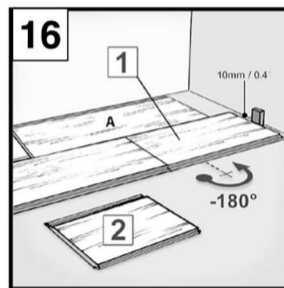
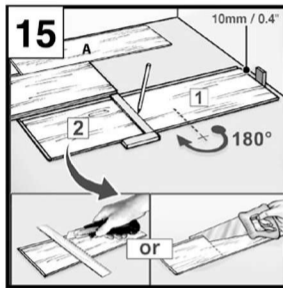
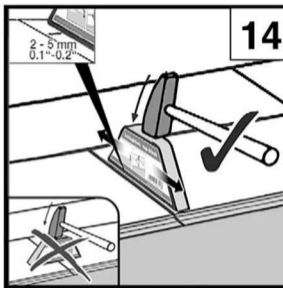
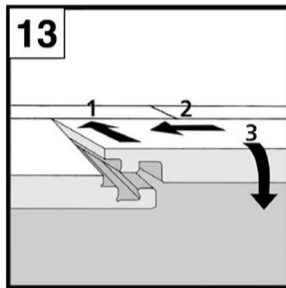
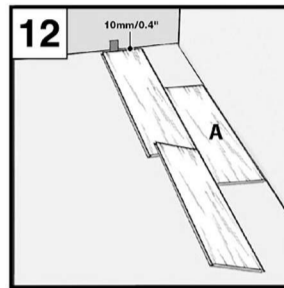
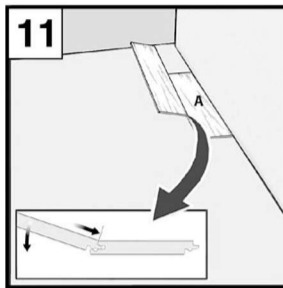
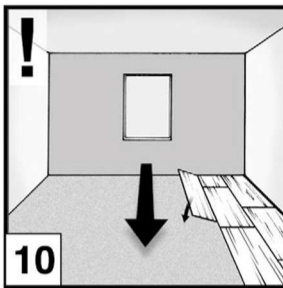
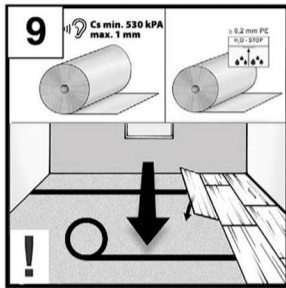
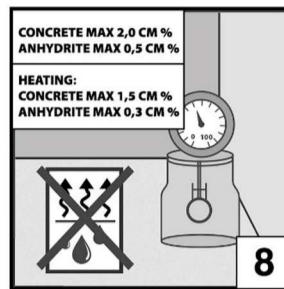
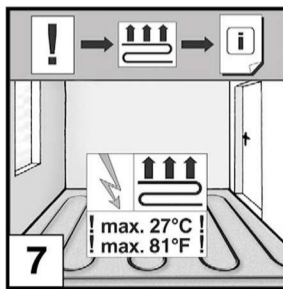
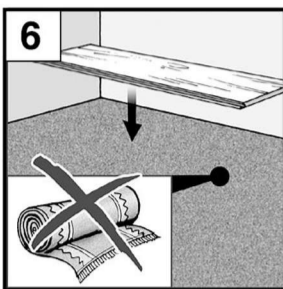
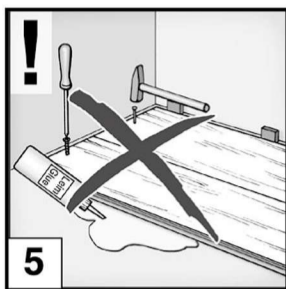
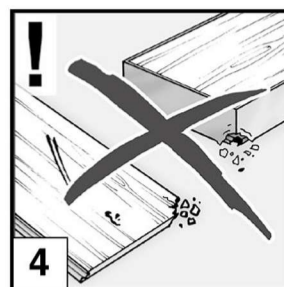
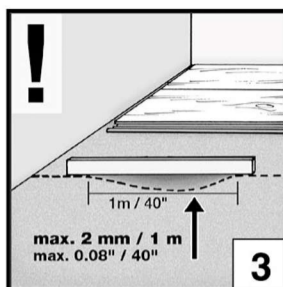

*opcjonalnie / optional / optionnel / optional / voliteľný / voliteľný / optional / opcional

Demontaž/ Disassembly/ Le Déassemblage/ Deinstallation/ Demontáž/ Demontare/ Deinstalación:

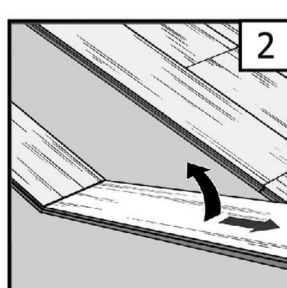
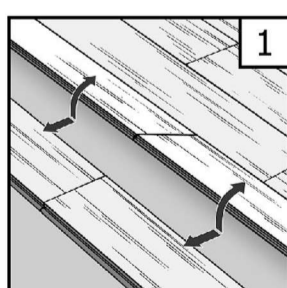

// PL: Przed instalacją podłogi, sprawdź także instrukcję montażu dostępną na stronie: www.rocko-vinyl.com
 // UWAGA: Przed montażem należy sprawdzić wszystkie panele pod kątem wad. Nie należy instalować żadnych paneli z widocznymi wadami (widocznymi z wysokości 1,5 m / 5 stóp).
 // EN: Before installing the floor, also refer to the online installation instructions: www.rocko-vinyl.com
 // NOTE: check all panels for defects before installation. Any panels with visual defects (visible from a height of 1.5m/ 5ft) should not be installed.
 // FR: Avant la pose, consultez les instructions de pose online sur: www.rocko-vinyl.com
 // INDICATIONS: Vérifiez les lames avant la pose. Une lame présentant un défaut visible (d'une hauteur de 1.5 m) ne doit pas être installée.
 // DE: Vor dem Verlegen ebenso die Online Verlegeanleitung beachten unter: www.rocko-vinyl.com
 // HINWEIS: Panele vor dem Verlegen kontrollieren. Bei evtl. Oberflächenfehlern (müssen erkennbar sein aus einer Abstandshöhe von 1,5 m) die betroffenen Paneele aussortieren!
 // SK: Pred inštaláciou podlahy si prečítajte aj pokyny na inštaláciu online: www.rocko-vinyl.com
 // POZNÁMKA: pred inštaláciou skontrolujte, či nie sú poškodené všetky panely. Nemali by sa inštalovať panely s vizuálnymi poruchami (viditeľné z výšky 1,5 m / 5 stóp).
 // CZ: Před instalací podlahy si přečtěte také pokyny k instalaci online: www.rocko-vinyl.com
 // POZNÁMKA: před instalací zkontrolujte, zda všechny panely nejsou poškozené. Panely se zrakovými vadami (viditelnými z výšky 1,5 m / 5 stop) by neměly být instalovány.
 // RO: Înainte de instalarea parchetului verificați instrucțiunile de montaj: www.rocko-vinyl.com
 // NOTA: verificați toate placile de parchet înainte de instalare. Orice placă cu defect vizibil de la o distanță de 1,5 metri nu se va monta.
 // ES: Antes de la instalación, por favor, consulte también las instrucciones de instalación online: www.rocko-vinyl.com
 // NOTE: Compruebe todas las almas antes de la instalación. Todas las laminas con defectos (visibles desde una distancia de 1.5m) no se deben instalar.

